

FED. ROAD DIST. NO.	STATE	JOB PIECE NO.	FISCAL YEAR	SHEET NO.	TOTAL SHEETS
6	OKLA.				

DESCRIPTION	REVISIONS	DATE

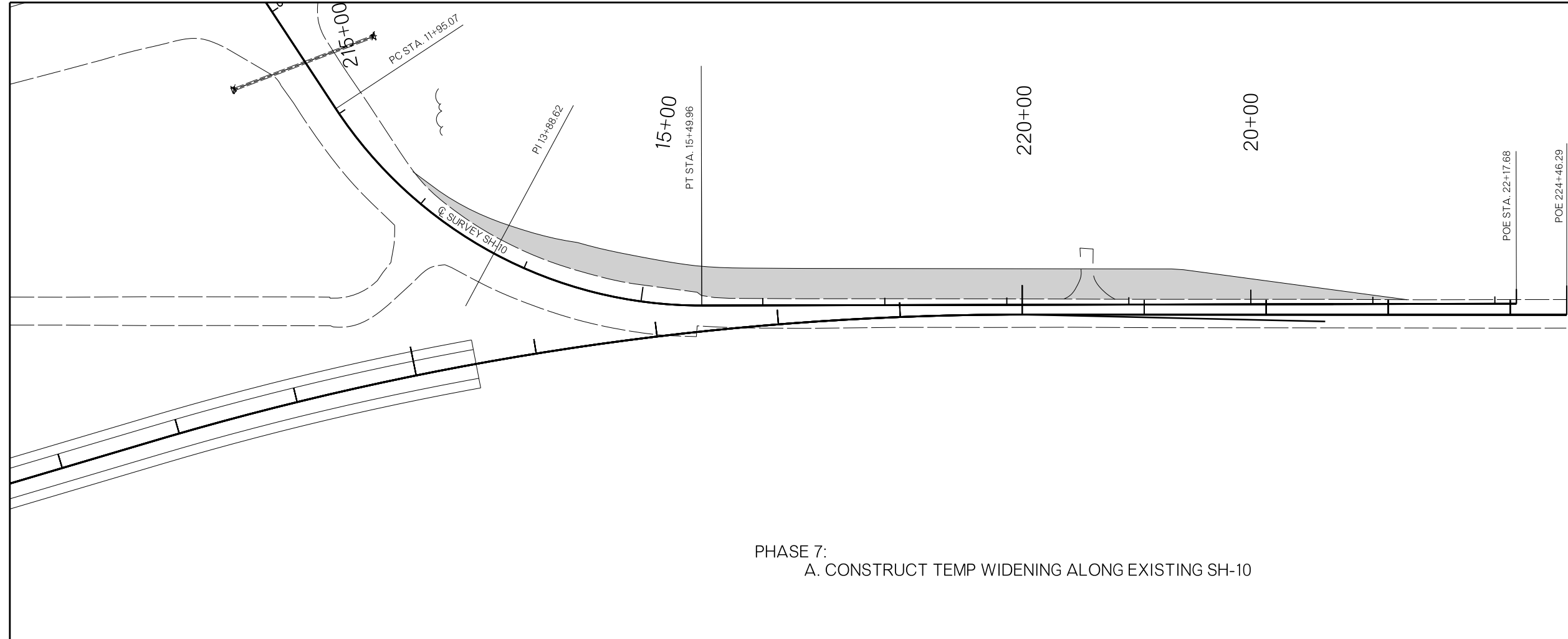

PHASE 7:  
A. CONSTRUCT TEMP WIDENING ALONG EXISTING SH-10

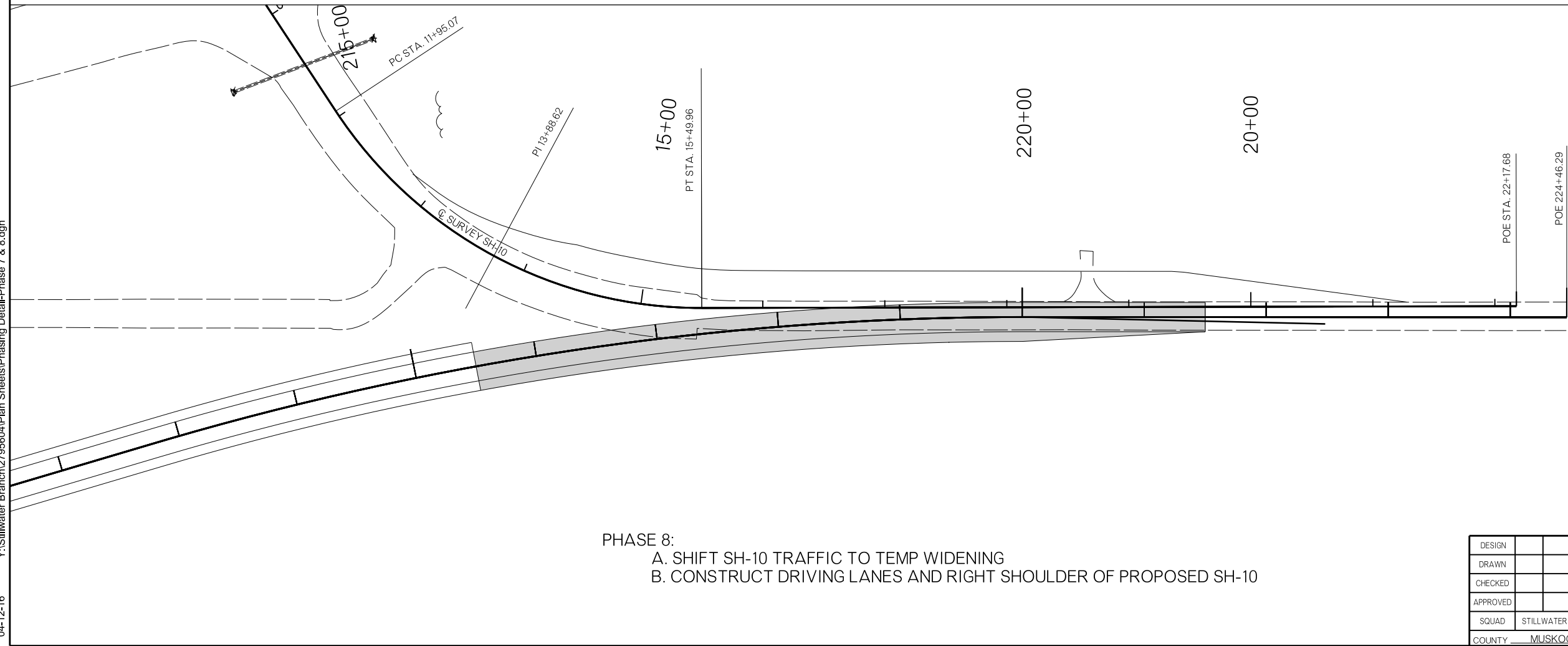

PHASE 8:  
A. SHIFT SH-10 TRAFFIC TO TEMP WIDENING  
B. CONSTRUCT DRIVING LANES AND RIGHT SHOULDER OF PROPOSED SH-10

DESIGN	
DRAWN	
CHECKED	
APPROVED	
SQUAD	STILLWATER

OKLAHOMA DEPARTMENT OF TRANSPORTATION  
ROADWAY DESIGN DIVISION

PHASING DETAIL:  
PHASE 7 & 8